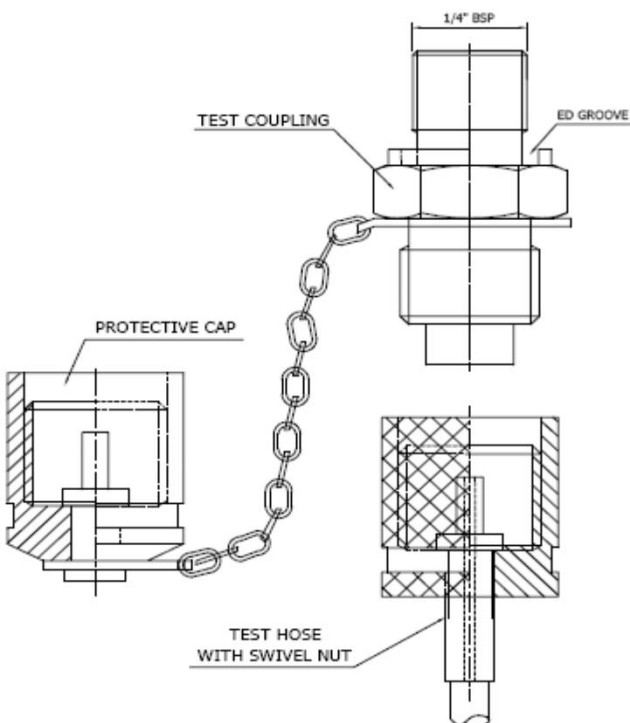
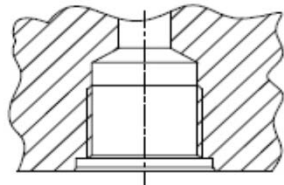

TEST COUPLINGS

**Test coupling for :**

- Monitoring and control of pressure.
- Venting
- Sampling in high and low-pressure systems

Advantages :

- Coupling at system pressure level.
- Leakproof before **ball valve** is open.
- Simple Connection to measuring, control and switching devices
- Self locking metal guard cap.

Working Pressure :

- Max, working pressure 630 bar.
- Brand Make - Imported
- Joining under pressure up to 400 bar max.

Materials :

- Metal parts: Steel zinc-plated and yellow chromated, Stainless steel on request
- Ball : Stainless steel
- Seals :
P = NBR (Temperature range -20°C to + 100°C)
(Internal Seals made of FPM (even at the standard NBR - type.
V = FPM (Temperature range -20°C to + 200°C)
E = EPDM Ethylene Propylene (for break fluid,
Temperature range -40°C to + 150°C)
- Hose Polyamide (Temperature range -35°C to + 100°C)
- Vibration safety O-ring made of NBR (standard)

Media :

- Suitable for hydraulic oils and other mineral oil based fluids
(Please pay attention to the sealing materials used)